

SCHEDULE OF DOORS & WINDOWS										
DOORS:					WINDOWS:					
MKD	WIDTH	HEIGHT	SILL	LINTEL	MKD	WIDTH	HEIGHT	SILL	LINTEL	
SW1	1500	2050	150	2200	W1	1500	1800	400	2200	
SW2	1800	2050	150	2200	W2	1200	1800	400	2200	
DR	900	2200	100	2200	WC	1200	1500	500	2200	
DOV	900	2200	00	2200	WSA	900	1800	500	2200	
D1	1100	2200	00	2200	W4	600	1800	400	2200	
D3	750	2200	00	2200	W4'	500	500	1500	2200	
SD1	2400	2200	00	2200	400	400	1450	400	2200	
SD	2100	2200	00	2200	SW	STAIRCASE WINDOW				At elevation
SD1	1800	2200	10	2200	GLZ	GLAZING				At elevation
GLZ	1800	2200	10	2200	GLZ1	900	1800	400	2200	
S03	1350	2200	00	2200	Vw	Ventilation Window				Above lintel
S04	1350	2200	00	2200						
F03	1200	2200	00	2200						
F02	750	2200	00	2200						

- NOTE:
- ALL DIMENSIONS ARE IN MM. UNLESS OTHERWISE MENTIONED.
  - ALL EXTERNAL WALLS ARE 160 THK & INTERNAL WALLS ARE 125 THK. IF NOT STATED IN 1:4 CEMENT SAND MORTAR.
  - ALL ELEVATION PROJECTIONS ARE 500 MM. PROJECTED.
  - DEPTH OF UNDERGROUND WATER RESERVOIR SHOULD NOT EXCEED THE DEPTH OF FOUNDATION.
  - ANY DISCREPANCY IN SCALE, THE WRITTEN DIMENSION SHALL GOVERN.
  - FOR SPECIFICATION OF MATERIALS & WORKMANSHIP N.B.C. 2016 TO BE FOLLOWED.
  - OPEN TERRACE WITH LIME TERRACING OF RATIO 2:2:7.
  - FLY ASH AND FLY ASH BASED MATERIAL WILL BE USED IN THE PROJECT.
  - SOLAR ENERGY OF 2% OF THE CONNECTED LOAD WILL BE USED IN THIS PROJECT.
  - FSR NO. : FSR/21/86240630000045
  - AA MEMO NO. KOLK/EAST/08/1022/68906

CERTIFICATE OF THE OWNER

I HAVE GONE THROUGH THE BUILDING RULES OF WEST BENGAL MUNICIPAL (BUILDING RULES), 2007 AND ITS AMENDMENT & ALSO UNDERTAKE TO ABIDE BY THOSE RULES DURING & AFTER THE CONSTRUCTION OF THE BUILDING.

SRIJAN RESIDENCY LLP  
  
 SRIJAN RESIDENCY LLP  
 36/1A, ELGIN ROAD  
 KOLKATA - 700020  
 SIGNATURE OF OWNER

CERTIFIED THAT THE STRUCTURAL DRAWINGS AND DESIGN OF BOTH THE FOUNDATION AND SUPERSTRUCTURE OF THE BUILDING/BUILDINGS HAS BEEN MADE CONSIDERING THE SOIL TEST REPORT AS PER THESE RULES AND REGULATIONS MADE UNDER THE ACT AND ALSO CONSIDERING ALL POSSIBLE LOADS, SEISMIC LOADS AND THE MOMENTS GENERATED BY THE PROPOSED STRUCTURE AS PER THE BUREAU OF INDIAN STANDARDS AND NATIONAL BUILDING CODES OF INDIA AND CERTIFIED THAT IT IS SAFE AND STABLE IN ALL RESPECT AND THESE PROVISIONS SHALL BE ADHERED TO DURING THE CONSTRUCTION.

ANKIT AGARWALA  
 S.E. CIVIL & EITD  
 S. ENG. REG. NO. 15138  
 REGISTERED STRUCTURAL ENGINEER  
 ENROLLMENT NO - STER/NKDA/10/00105  
 SIGNATURE OF STRUCTURAL ENGINEER

UPTAL SANTHA  
 S.E. CIVIL & EITD  
 S. ENG. REG. NO. 15138  
 REGISTERED STRUCTURAL ENGINEER  
 ENROLLMENT NO - STR/NKDA/15/00006  
 SIGNATURE OF STRUCTURAL REVIEWER

IT IS CERTIFIED THAT THE COMPREHENSIVE GEO-TECHNICAL REPORT ON SOIL INVESTIGATION HAS BEEN PREPARED BY ME FOR DESIGN AND CALCULATION OF THE FOUNDATION BY ANALYZING THE SOIL SAMPLE FOR ESTIMATING THE BEARING CAPACITY OF THE SOIL ON WHICH FOUNDATION OF THE STRUCTURE WILL BE CONSTRUCTED.

I SHALL ALSO CHECK THE NATURE OF THE SOIL AFTER EXCAVATION AT SITE SO THAT FOUNDATION IS EXTENDED UP TO APPROPRIATE DEPTH THAT HAS BEEN PROPOSED IN THE GEO-TECHNICAL REPORT.

JISHNU PAL  
 S.E. CIVIL & EITD  
 S. ENG. REG. NO. 15138  
 REGISTERED GEO-TECHNICAL ENGINEER  
 ENROLLMENT NO - GTR/NKDA/10/00043  
 SIGNATURE OF GEOTECHNICAL ENGINEER

SIGNATURE OF THE ARCHITECT

KAMAL KUMAR PERIWAL  
 CA-95-18679  
 SIGNATURE OF ARCHITECT  
 KAMAL KUMAR PERIWAL  
 ENROLLMENT NO - ACHR/NKDA/10/00016  
 C.O.A REGISTRATION NO- CA-95-18679

ARPAN DAS GUPTA  
 B. Arch (U), I. P.P. (IBST)  
 ARCHITECT, I. W/ PLANNER  
 Emp. No. - TRER/ (DA)/20/00003  
 Signature of Town Planner  
 ARPAN DASGUPTA  
 ENROLLMENT NO- TPER/NKDA/20/00003

PROJECT :

PROPOSED G+18(TOWER B,E,G) G+19(TOWER A,C,D,F) STORIED RESIDENTIAL BUILDING MAUZA-KALABERIA, JL NO.30, LR DAG NO : 1, 2, 3, 4, 5, 11(P), 12, 13, 14, 15, 16, 17, 18, 19, 20, 21, 22, 23, 24, 25, 26, 27(P), 28(P), 42, 43(P), 44(P), 74, 79, 80 & MAUZA BHATENDA, JL NO.28, LR DAG NO: 485,486,488, PS- RAJARHAT, RAJARHAT-BISNUPUR 1 NO GRAM PANCHAYAT, NORTH 24 PGS, PIN - 700135

CONTENTS :

BLOCK 2 - TOWER D - 19TH FLOOR PLAN & ROOF PLAN

SUBMISSION DRAWING	SHEET NO. - 18/37		
NORTH	MA/RAJARHAT/SUB/ARCH/S-18		
REV. DATE	-	REV. NO.	-
SCALE	1:100	DEALT	-
DATE	09.03.2024	CHECKED	M.B.

ARCHITECT :

MAHESHWARI & ASSOCIATES  
 37A, BAKER ROAD, 2ND FLOOR, ALIPORE,  
 KOLKATA-27  
 TEL. : 65228584, www.architectm.com

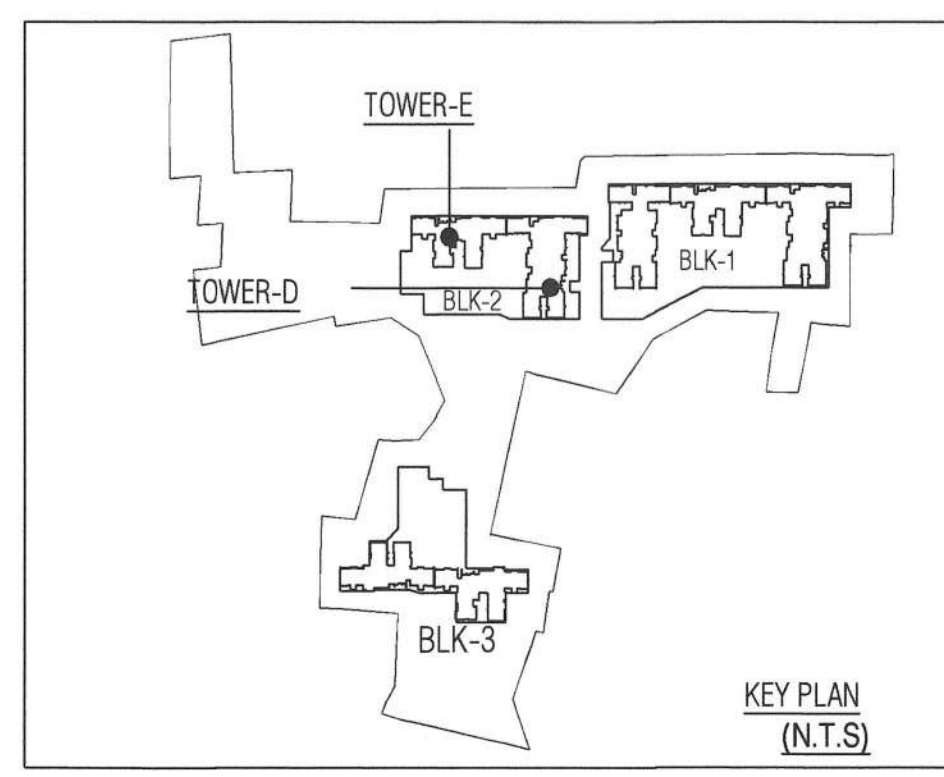

PROJECT NO.	14627/NKDA/BPS/202/2023
DATE OF ISSUE	01.10.2024
ISSUED TO	MR. RAJESH K. SINGH
ISSUED BY	MR. RAJESH K. SINGH
ISSUED FOR	CONSTRUCTION

Note: This NOC has been issued on the basis of documents submitted by the applicant and forwarded by the JdP, Executive Officer, North 24 Parganas Zilla Parishad. If there was material misrepresentation of fact or fraudulent act in any act of suppression of fact in connection with the above project including the concerned and plan, drawings, design etc., then this NOC shall stand cancel.

STRUCTURAL DRAWINGS, STRUCTURAL DESIGN CALCULATIONS & SOIL TEST REPORT ARE NOT CHECKED AND KEPT FOR RECORD ONLY.

SANCTIONED & APPROVED  
*[Signature]*  
 Executive Officer  
 Rajarhat Panchayat Samity  
 Rajarhat, North 24 Parganas

NEW TOWN KOLKATA DEVELOPMENT AUTHORITY  
 No Objection Certificate for  
 Sanction of Building Plan for Construction Purpose  
 Memo No. 14627/NKDA/BPS/202/2023  
 Date: 01.10.2024

NOTE: ALL RECOMMENDATIONS FROM POLLUTION CONTROL BOARD SHOULD BE THOROUGHLY FOLLOWED AT THE TIME OF CONSTRUCTION.

Building Particulars: No Objection Certificate for issuance of completion certificate of proposed G+18 (TOWER A, E, G) (G+18 (TOWER A, C, D, F) stored residential building (Mixed Residential) Plot No. 2, UR Div No. 1, 2, 3, 4, 5, 119A, 12, 13, 14, 15, 16, 17, 18, 19, 20, 21, 22, 23, 24, 25, 26, 27, 28, 29, 30, 31, 32, 33, 34, 35, 36, 37, 38, 39, 40, 41, 42, 43, 44, 45, 46, 47, 48, 49, 50, 51, 52, 53, 54, 55, 56, 57, 58, 59, 60, 61, 62, 63, 64, 65, 66, 67, 68, 69, 70, 71, 72, 73, 74, 75, 76, 77, 78, 79, 80, 81, 82, 83, 84, 85, 86, 87, 88, 89, 90, 91, 92, 93, 94, 95, 96, 97, 98, 99, 100, 101, 102, 103, 104, 105, 106, 107, 108, 109, 110, 111, 112, 113, 114, 115, 116, 117, 118, 119, 120, 121, 122, 123, 124, 125, 126, 127, 128, 129, 130, 131, 132, 133, 134, 135, 136, 137, 138, 139, 140, 141, 142, 143, 144, 145, 146, 147, 148, 149, 150, 151, 152, 153, 154, 155, 156, 157, 158, 159, 160, 161, 162, 163, 164, 165, 166, 167, 168, 169, 170, 171, 172, 173, 174, 175, 176, 177, 178, 179, 180, 181, 182, 183, 184, 185, 186, 187, 188, 189, 190, 191, 192, 193, 194, 195, 196, 197, 198, 199, 200, 201, 202, 203, 204, 205, 206, 207, 208, 209, 210, 211, 212, 213, 214, 215, 216, 217, 218, 219, 220, 221, 222, 223, 224, 225, 226, 227, 228, 229, 230, 231, 232, 233, 234, 235, 236, 237, 238, 239, 240, 241, 242, 243, 244, 245, 246, 247, 248, 249, 250, 251, 252, 253, 254, 255, 256, 257, 258, 259, 260, 261, 262, 263, 264, 265, 266, 267, 268, 269, 270, 271, 272, 273, 274, 275, 276, 277, 278, 279, 280, 281, 282, 283, 284, 285, 286, 287, 288, 289, 290, 291, 292, 293, 294, 295, 296, 297, 298, 299, 300, 301, 302, 303, 304, 305, 306, 307, 308, 309, 310, 311, 312, 313, 314, 315, 316, 317, 318, 319, 320, 321, 322, 323, 324, 325, 326, 327, 328, 329, 330, 331, 332, 333, 334, 335, 336, 337, 338, 339, 340, 341, 342, 343, 344, 345, 346, 347, 348, 349, 350, 351, 352, 353, 354, 355, 356, 357, 358, 359, 360, 361, 362, 363, 364, 365, 366, 367, 368, 369, 370, 371, 372, 373, 374, 375, 376, 377, 378, 379, 380, 381, 382, 383, 384, 385, 386, 387, 388, 389, 390, 391, 392, 393, 394, 395, 396, 397, 398, 399, 400, 401, 402, 403, 404, 405, 406, 407, 408, 409, 410, 411, 412, 413, 414, 415, 416, 417, 418, 419, 420, 421, 422, 423, 424, 425, 426, 427, 428, 429, 430, 431, 432, 433, 434, 435, 436, 437, 438, 439, 440, 441, 442, 443, 444, 445, 446, 447, 448, 449, 450, 451, 452, 453, 454, 455, 456, 457, 458, 459, 460, 461, 462, 463, 464, 465, 466, 467, 468, 469, 470, 471, 472, 473, 474, 475, 476, 477, 478, 479, 480, 481, 482, 483, 484, 485, 486, 487, 488, 489, 490, 491, 492, 493, 494, 495, 496, 497, 498, 499, 500, 501, 502, 503, 504, 505, 506, 507, 508, 509, 510, 511, 512, 513, 514, 515, 516, 517, 518, 519, 520, 521, 522, 523, 524, 525, 526, 527, 528, 529, 530, 531, 532, 533, 534, 535, 536, 537, 538, 539, 540, 541, 542, 543, 544, 545, 546, 547, 548, 549, 550, 551, 552, 553, 554, 555, 556, 557, 558, 559, 560, 561, 562, 563, 564, 565, 566, 567, 568, 569, 570, 571, 572, 573, 574, 575, 576, 577, 578, 579, 580, 581, 582, 583, 584, 585, 586, 587, 588, 589, 590, 591, 592, 593, 594, 595, 596, 597, 598, 599, 600, 601, 602, 603, 604, 605, 606, 607, 608, 609, 610, 611, 612, 613, 614, 615, 616, 617, 618, 619, 620, 621, 622, 623, 624, 625, 626, 627, 628, 629, 630, 631, 632, 633, 634, 635, 636, 637, 638, 639, 640, 641, 642, 643, 644, 645, 646, 647, 648, 649, 650, 651, 652, 653, 654, 655, 656, 657, 658, 659, 660, 661, 662, 663, 664, 665, 666, 667, 668, 669, 670, 671, 672, 673, 674, 675, 676, 677, 678, 679, 680, 681, 682, 683, 684, 685, 686, 687, 688, 689, 690, 691, 692, 693, 694, 695, 696, 697, 698, 699, 700, 701, 702, 703, 704, 705, 706, 707, 708, 709, 710, 711, 712, 713, 714, 715, 716, 717, 718, 719, 720, 721, 722, 723, 724, 725, 726, 727, 728, 729, 730, 731, 732, 733, 734, 735, 736, 737, 738, 739, 740, 741, 742, 743, 744, 745, 746, 747, 748, 749, 750, 751, 752, 753, 754, 755, 756, 757, 758, 759, 760, 761, 762, 763, 764, 765, 766, 767, 768, 769, 770, 771, 772, 773, 774, 775, 776, 777, 778, 779, 780, 781, 782, 783, 784, 785, 786, 787, 788, 789, 790, 791, 792, 793, 794, 795, 796, 797, 798, 799, 800, 801, 802, 803, 804, 805, 806, 807, 808, 809, 810, 811, 812, 813, 814, 815, 816, 817, 818, 819, 820, 821, 822, 823, 824, 825, 826, 827, 828, 829, 830, 831, 832, 833, 834, 835, 836, 837, 838, 839, 840, 841, 842, 843, 844, 845, 846, 847, 848, 849, 850, 851, 852, 853, 854, 855, 856, 857, 858, 859, 860, 861, 862, 863, 864, 865, 866, 867, 868, 869, 870, 871, 872, 873, 874, 875, 876, 877, 878, 879, 880, 881, 882, 883, 884, 885, 886, 887, 888, 889, 890, 891, 892, 893, 894, 895, 896, 897, 898, 899, 900, 901, 902, 903, 904, 905, 906, 907, 908, 909, 910, 911, 912, 913, 914, 915, 916, 917, 918, 919, 920, 921, 922, 923, 924, 925, 926, 927, 928, 929, 930, 931, 932, 933, 934, 935, 936, 937, 938, 939, 940, 941, 942, 943, 944, 945, 946, 947, 948, 949, 950, 951, 952, 953, 954, 955, 956, 957, 958, 959, 960, 961, 962, 963, 964, 965, 966, 967, 968, 969, 970, 971, 972, 973, 974, 975, 976, 977, 978, 979, 980, 981, 982, 983, 984, 985, 986, 987, 988, 989, 990, 991, 992, 993, 994, 995, 996, 997, 998, 999, 1000.

Approval Order No. 1691/RPS  
 Date: 25/10/2024  
 Valid up to: 25/10/2029

*[Signature]*  
 Assistant Architect  
 New Town Kolkata Development Authority

*[Signature]*  
 Executive Architect  
 New Town Kolkata Dev. Authority

*[Signature]*  
 Executive Engineer  
 New Town Kolkata Development Authority

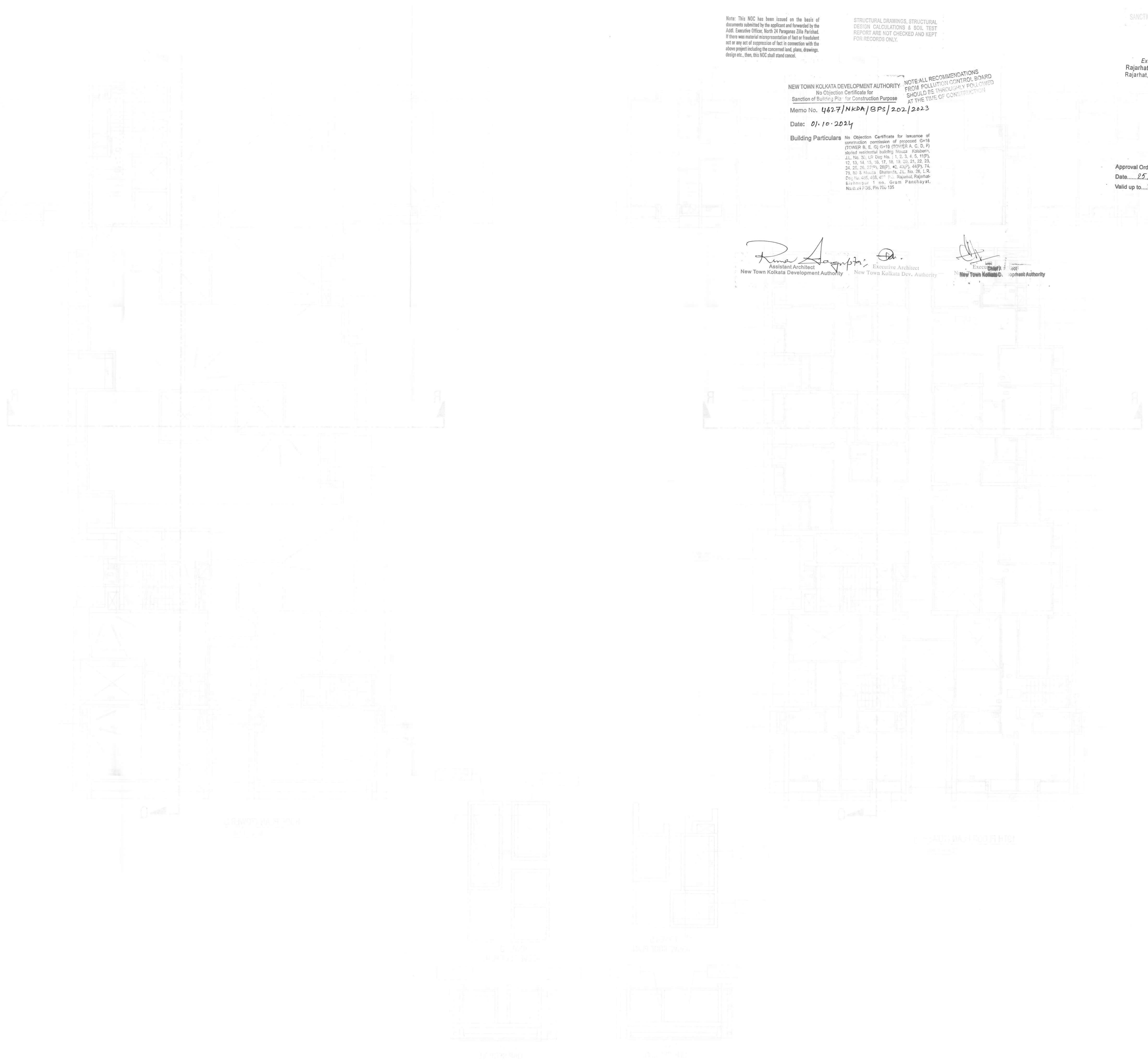

1. GENERAL NOTES

2. MATERIALS

3. FINISHES

4. STRUCTURAL NOTES

5. ELECTRICAL NOTES

6. PLUMBING NOTES

7. MECHANICAL NOTES

8. SANITARY NOTES

9. PAINTS

10. GLAZING

11. FLOORING

12. ROOFING

13. EXTERIOR FINISHES

14. INTERIOR FINISHES

15. LIGHTING

16. SOUNDING

17. VENTILATION

18. HEATING

19. COOLING

20. AIR CONDITIONING

21. FIRE PROTECTION

22. SAFETY

23. ACCESSIBILITY

24. ENVIRONMENTAL

25. SUSTAINABILITY

26. ENERGY EFFICIENCY

27. WATER SAVING

28. WASTE MANAGEMENT

29. HEALTH AND SAFETY

30. COMPLIANCE